

PERI QuickSolve | Bridge Planner

The planning tool to estimate your bridge project

Quick and intuitive planning

for your bridge project. Define structure and configure formwork in few steps.

Use safely

due to integrated statical verification and visual summary. Inspect and approve without additional time investment.

Flexible use of material

based on material availability. Use for bids or during the plan and execution phases, including spontaneous changes during the project.



Start your bridge project
with PERI QuickSolve



Formwork
Scaffolding
Engineering

www.peri.com

PERI QuickSolve | Bridge Planner

The planning tool to estimate your bridge project

PERI QuickSolve is the quick and easy application for planning bridge projects with the VARIOKIT Pier System (VPS). Depending on the pier geometry and formwork system parameters selected, PERI QuickSolve will verify your project statically, provide a solution overview, as well as material estimation and documentation with 2D views.

All you need to do is enter some basic variables of your project, such as the number of columns, the form of the pier cap, which concrete mix is used, and some formwork system features. The rest is done by the application. What's more, the plans can be adapted spontaneously to changing situations on your construction site. The web application is available 24/7 and can be used for planning bridges. It is free of charge and browser based, thus, no installation is needed. It runs on Computers or Tablets alike, thus is a simple to use solution.

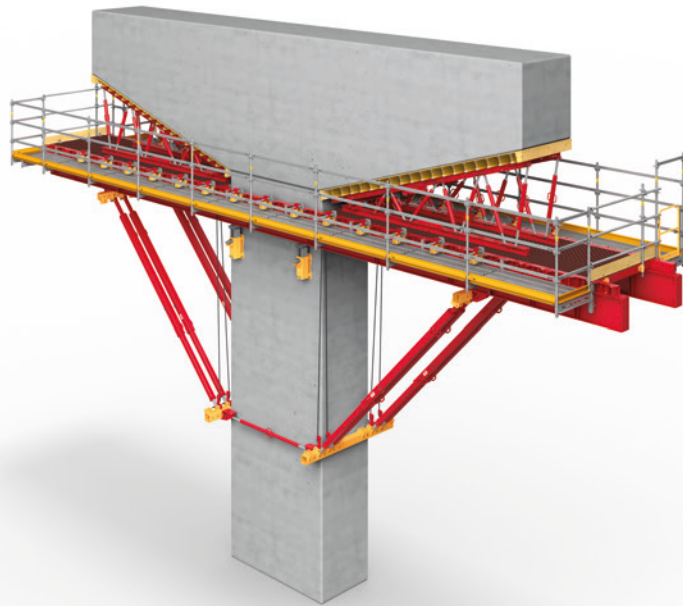

PERI QuickSolve is able to plan bridge pier heads. It is a powerful tool that can help you reduce material and labour costs based on sophisticated statical verification and simplified planning taking into account your inventory. The planning is adaptable to changes in your project. It is accessible with computers or tablets and browser based, thus you can use it independent of your actual location.

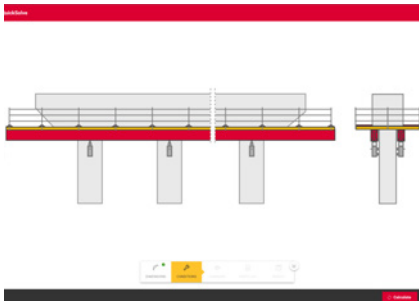

The first step is to enter variables of your project, and select some basic layout features.

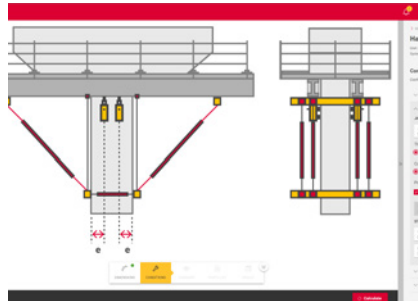

Despite the apparent simplicity of PERI QuickSolve, the application verifies and estimates material requirements for complex geometries.

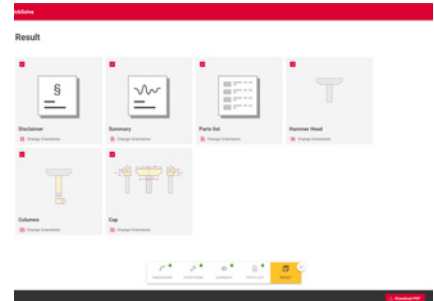

PERI QuickSolve results are summarized and can be exported as PDF.

Start to QuickSolve your project:

PERI QuickSolve planning modules are powerful and effective tools enabling you to work faster and thus to be more efficient on your project. With PERI QuickSolve, you have a useful tool at your disposal that makes your life easier.

PERI QuickSolve helps you to simplify your project:

- It is easy to use, planning is very intuitive
- It takes into account your needs and the material of your choice
- It is free of charge and can be used wherever you need it



Formwork
Scaffolding
Engineering

www.peri.com